

## HY-WDC2E Ultrasonic Wind speed and Wind direction sensor

### Brief Introduction

HY-WDC2E Ultrasonic Anemometer is designed to simultaneously measure the 2-dimensional horizontal components of the wind speed and direction based on principle of TOF(time of flight) of ultrasonic sound wave. Low power chip make its power consumption low to 0.2W. By using ABS shell allows a lighter weight and robust structure.



### Key Features

- Low to 0.1W consumption
- No moving or wearing parts
- Anti-corrosion
- No inertia problem
- Sensitive and prompt response
- Easy installation
- No need to re-calibrate
- No dead band 0-359°

### Specification

Parameters	Measure Range	Accuracy	Resolution
Wind Speed	0-40m/s(77 knots)	±5%	0.1m/s(0.2 knots)
Wind Direction	0-359°	±3°	1°
Threshold of wind speed: 0.1m/s			
Output rate	1 data per second		
Power supply	5-30VDC 20mA@5VDC		
Start up time	< 5 seconds		
Protection Class	IP65		
Operating Temp.	-40℃ to +60℃		
Storage Temp.	-50℃ to +80℃		
Output options	RS232,RS485,SDI-12,4-20mA		
Color options	White-default or Black		
Optional protocol	MODBUS-RTU,NEMA0183,Active output in ASCII,SDI-12		
Dimension	Φ84×120mm		
Material of body	ABS 0.38kg or aluminium alloy 0.7kg		
Warranty	24 months; Mean Time Before Failure: 10 years		
Certification	CE		

Specifications may be subject to change without prior notice.

## Typical Applications

- Highway
- Fire weather monitoring
- Air Pollution
- Bridge monitoring
- Smart city weather station
- Agriculture
- Roadside smart lamp



## Dimension

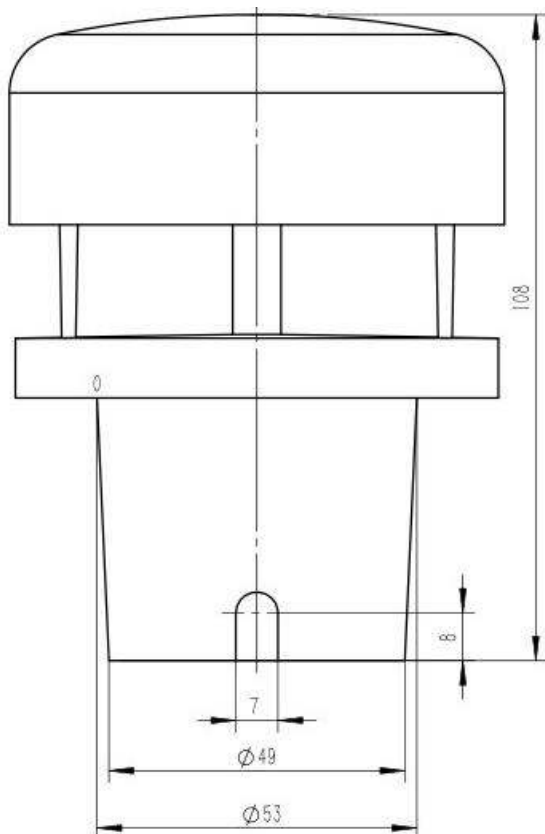

## Option mounting bracket(\$20)

